

Linear Ball Bushing

The outer sheel is made of steel, the cage is plastic. Balls are Grade 10. Bushings are available with seals at one or both ends.

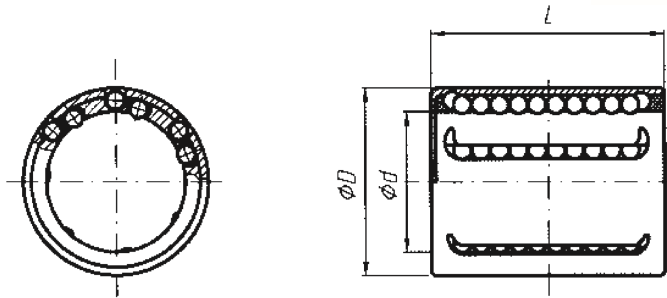
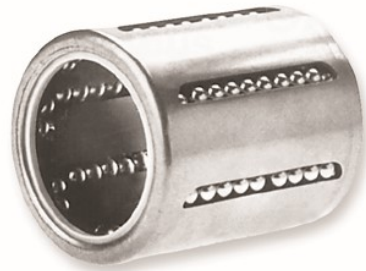

Linear Ball Bushings

Dimensions in mm

Part-No.	∅ d	∅ D	L	load capacity (N)		weight (g)
				dyn	stat.	
KH-0622	6	12	22	400	239	7
KH-0824	8	15	24	435	280	12
KH-1026	10	17	26	500	370	14,5
KH-1228	12	19	28	620	510	18,5
KH-1428	14	21	28	620	520	20,5
KH-1630	16	24	30	800	620	27,5
KH-2030	20	28	30	950	790	32,5
KH-2540	25	35	40	1.990	1.670	66
KH-3050	30	40	50	2.800	2.700	95
KH-4060	40	52	60	4.400	4.450	182
KH-5070	50	62	70	5.500	6.300	252

Load ratings only apply in connection with hardened and ground shafts, please refer to chapter 5

Ordering code

KH-	∅-	PP
standard linear ball bushing	shaft diameter	P seal one end PP seal both ends