



Item no: 3150050P

Suction cup F40-2 Nitrile-PVC, 1/8" NPSF female, with cone valve

Suitable for flat objects such as cardboard, sheet metal, glass and porous materials. The cleats stop deformation by preventing suction of the object into the cup. The suction cup has good stability and very little movement. Also suitable when the lifting force is parallel to the surface as the cleats increase friction.

- Suitable for flat objects.
- Good stability and little inherent movement.
- Recommended when the lifting force is parallel to the surface of the object.
- Cleats prevent thin, sensitive objects from being deformed and gives extra friction when the lifting force is parallel.

General

| | |
|-------------------------|---------------------|
| Application | Dry sheet metal |
| Suction cup shape | Flat |
| Material | Nitrile-PVC (NPV) |
| Suction cup model | F |
| Weight | 5.5 g |
| Volume | 4.8 cm ³ |
| Suction cup model | F40-2 |
| Movement, vertical max. | 1.8 mm |
| Curve radius, min. | 52 mm |



Fitting

| | |
|----------------|-------------|
| Fitting option | Cone valve |
| Fitting size | 1/8" |
| Fitting style | Female |
| Fitting type | NPSF-thread |

Dimension

| | |
|--------------------------|---------|
| Height | 21 mm |
| Outer diameter, actuated | 43.7 mm |
| Outer diameter | 42 mm |

Performance - lifting forces

| | F40-2 |  |  |
|---------|-------|---|--|
| 20 -kPa | | 20 N | 15 N |
| 60 -kPa | | 40 N | 25 N |
| 90 -kPa | | 50 N | 30 N |

Material

| | |
|-------------|-------------|
| Name | NPV |
| Colour | Black |
| Temperature | 0 - 90 °C |
| Hardness | 50 °Shore A |

| | |
|--------------------|-----|
| | NPV |
| Alcohol | ++ |
| Concentrated acids | + |
| Ethanol | n/a |
| Hydrolysis | ++ |
| Methanol | n/a |
| Oil | +++ |
| Oxidation | ++ |
| Petrol | +++ |
| Wear resistance | +++ |
| Weather and ozone | ++ |

Dimensional drawings 

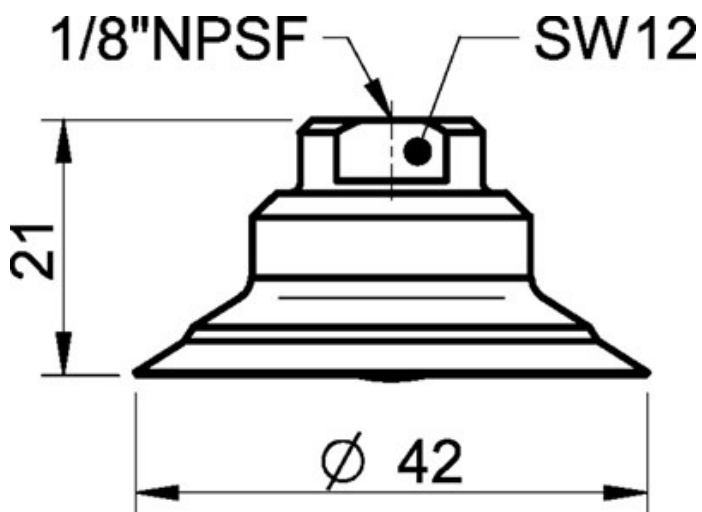

Values specified in the data sheet are tested at:

- Room temperature: (20°C [68°F] ± 3°C [5.5°F])
 - Standard atmosphere: (101.3 [29.9 inHg] ± 1.0 kPa [0.3 inHg])
 - Relative humidity: 0-100%
 - Compressed air quality: DIN ISO 8573-1 class 4
-

Accessories

| | | |
|---------|--|---|
| 3251008 | | Fitting 1/4" NPT male, with dual flow control valve |
| 3250093 | | Fitting 1/4" NPT male, with mesh filter |
| 3250005 | | Fitting 1/8" NPSF female, 30–40 |
| 3150197 | | Fitting 1/8" NPSF female, 30–40, PA |
| 3251006 | | Fitting 1/8" NPSF female, 30–40, with dual flow control valve |
| 0101153 | | Fitting 1/8" NPSF female, 30–40, with mesh filter |
| 3251010 | | Fitting 3/8" NPT male, with dual flow control valve |
| 3250089 | | Fitting 3/8" NPT male, with mesh filter |
| 0100261 | | Fitting 5x1/8" NPSF female, 30–40 |
| 3251011 | | Fitting 5x1/8" NPSF female, 30–40, with dual flow control valve |
| 3250091 | | Fitting G1/4" male, 30–40, with mesh filter |
| 3251007 | | Fitting G1/4" male, 30–40, with mesh filter and dual flow control valve |
| 3251009 | | Fitting G3/8" male, 30–40, with mesh and dual flow control valve |
| 3250086 | | Fitting G3/8" male, 30–40, with mesh filter |
| 0101136 | | Suction cup F40-2 Silicone |

Spare parts

| | | |
|---------|--|--|
| 0101156 | | Fitting 1/8" NPSF female, 30–40, with cone valve |
| 0101135 | | Suction cup F40-2 Nitrile-PVC |